

# Oil Flow Control Solenoid Valve

FUEL INJECTION (FUEL SYSTEMS)

## 14.Oil Flow Control Solenoid Valve

### A: REMOVAL

#### 1. INTAKE SIDE

Oil flow control solenoid valve is a unit with front camshaft cap.

Refer to "Camshaft" for removal procedures. <Ref. to ME(STI)-62, REMOVAL, Camshaft.>

#### 2. EXHAUST SIDE

- 1) Disconnect the ground cable from battery.
- 2) Lift up the vehicle.
- 3) Remove the under cover. <Ref. to EI-21, REMOVAL, Front Under Cover.>
- 4) Remove the front exhaust pipe. (right side only.) <Ref. to EX(STI)-5, REMOVAL, Front Exhaust Pipe.>
- 5) Remove the engine harness cover. (right side only.)

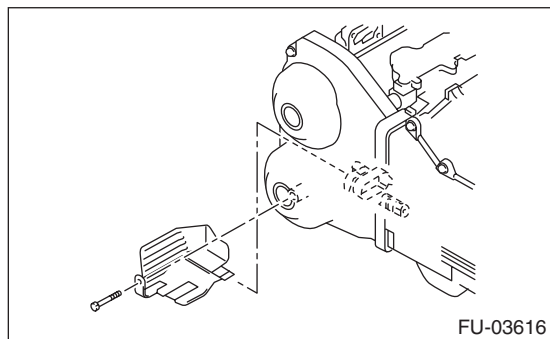

- 6) Remove the clip holding the engine harness. (Left side only)

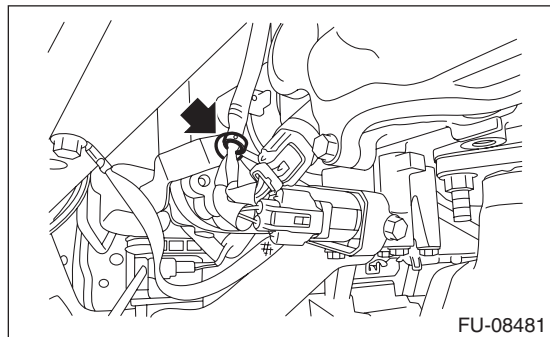

- 7) Disconnect the ground cable (A). (Left side only)

- 8) Disconnect the connector (B) from the oil flow control solenoid valve, and remove the oil flow control solenoid valve from the cylinder head.

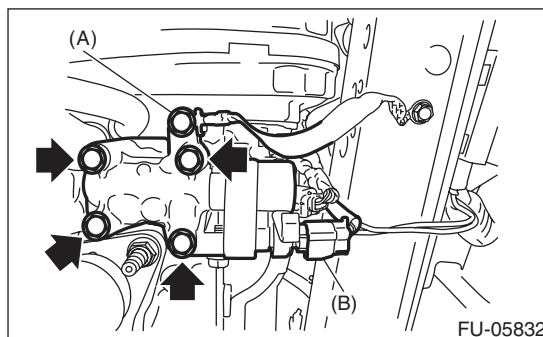

### B: INSTALLATION

#### 1. INTAKE SIDE

Refer to "Camshaft" for installation procedure. <Ref. to ME(STI)-64, INSTALLATION, Camshaft.>

#### 2. EXHAUST SIDE

Install in the reverse order of removal.

NOTE:

Use a new gasket.

**Tightening torque:**

**T1: 7.5 N·m (0.8 kgf-m, 5.5 ft-lb)**

**T2: 10 N·m (1.0 kgf-m, 7.4 ft-lb)**

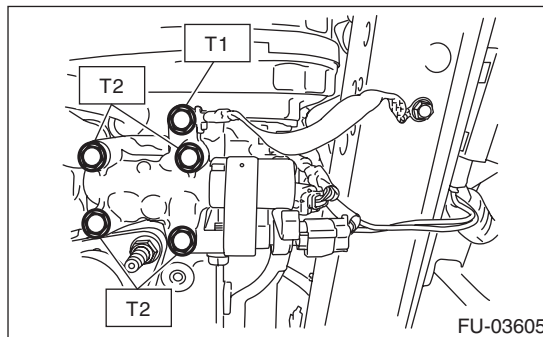

**Tightening torque:**

**5 N·m (0.5 kgf-m, 3.7 ft-lb)**

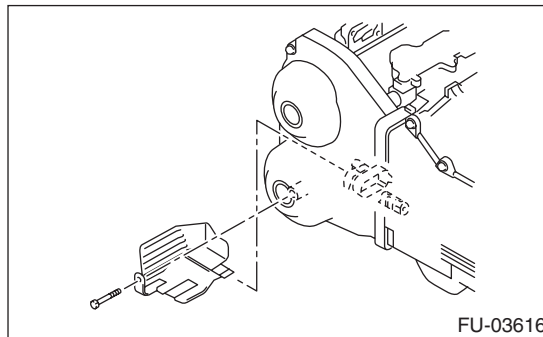

# Oil Flow Control Solenoid Valve

FUEL INJECTION (FUEL SYSTEMS)

## C: DISASSEMBLY

### 1. INTAKE SIDE

- 1) Remove the two mounting bolts securing oil return cover, and remove the oil return cover and gasket.
- 2) Remove the bolt securing oil flow control solenoid valve, and remove the oil flow control solenoid valve.

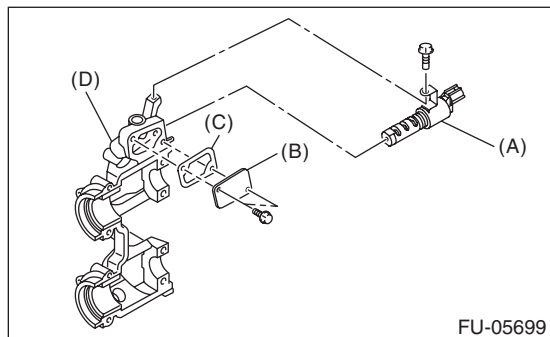

- (A) Oil flow control solenoid valve
- (B) Oil return cover
- (C) Gasket
- (D) Front camshaft cap

### 2. EXHAUST SIDE

The oil flow control solenoid valve on the exhaust side cannot be disassembled.

## D: ASSEMBLY

### 1. INTAKE SIDE

- 1) Install the oil flow control solenoid valve.

**Tightening torque:**

**6.4 N·m (0.7 kgf-m, 4.7 ft-lb)**

- 2) Apply liquid gasket to the two bolts securing oil return cover.

**Liquid gasket:**

**THREE BOND 1324 (Part No. 004403042) or equivalent**

- 3) Attach the oil return cover and gasket.

**Tightening torque:**

**9 N·m (0.9 kgf-m, 6.6 ft-lb)**

**NOTE:**

Use a new gasket.

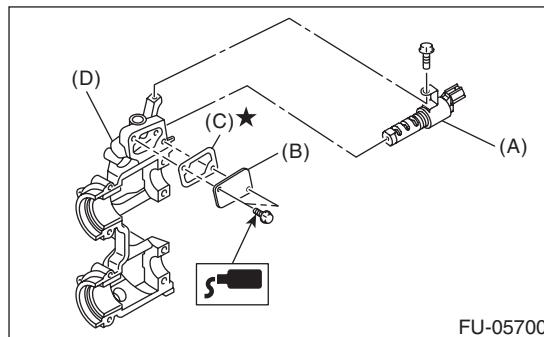

- (A) Oil flow control solenoid valve
- (B) Oil return cover
- (C) Gasket
- (D) Front camshaft cap

### 2. EXHAUST SIDE

The oil flow control solenoid valve on the exhaust side cannot be disassembled.

## E: INSPECTION

- 1) Check that the oil flow control solenoid valve has no deformation, cracks or other damages.
- 2) Measure the resistance between the oil flow control solenoid valve terminals.

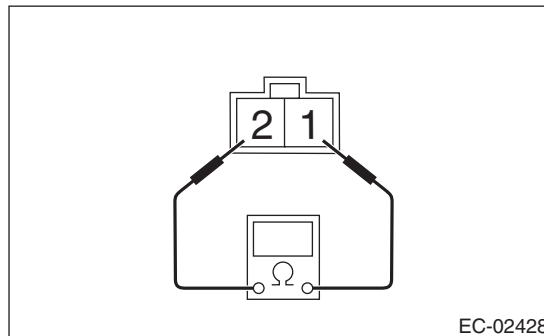

| Terminal No. | Standard                     |
|--------------|------------------------------|
| 1 and 2      | 7.4±0.5 Ω (when 20°C (68°F)) |